

Instructions for Operation of 5111A Ferrule Crimper

Description

The 5111A ferrule crimper is hand operated. It is used in a fixed location for small production runs, or mounted on a carrier as a mobile hose repair unit.

The 5111A crimper is designed for the production or repair of hoses using light or medium weight ferrules and stems for air or water hose.

Installation

The 5111A ferrule crimper is shipped fully assembled, (except for installing handle), less crimping dies. It should be secured to a bench or carrier.

Maintenance

The 5111A ferrule crimper is greased at time of assembly. Periodic inspection, cleaning, and greasing of all moving parts is necessary (use a WD40 type spray).

Operation

1. Install proper stem and ferrule onto hose.
2. Place assembly into opening between the crimping dies and pull handle No. 3 until crimping dies contact ferrule. A steady pull on the handle will bring the dies through center completing the crimping operation.

Die Change

1. Remove wing nuts No. 2. Die holder plate No. 1 can now be removed exposing the crimping dies as well as the die holders No.4, links No. 5, and their pins Nos. 6 and 7.
2. Crimping dies will slide in and out of the mating dovetails freely.
3. All crimping dies are stamped with their part number. When the die holder plate is removed, this number is visible on each die. When changing dies, be sure to install each die with the numbered side facing the die holder plate. This is very important when using ribbed dies for proper rib orientation.

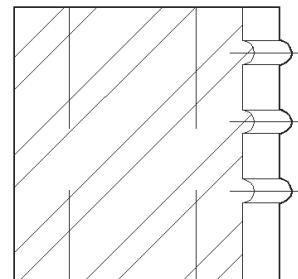
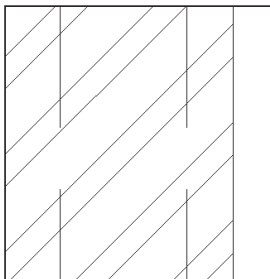

5111A Crimper

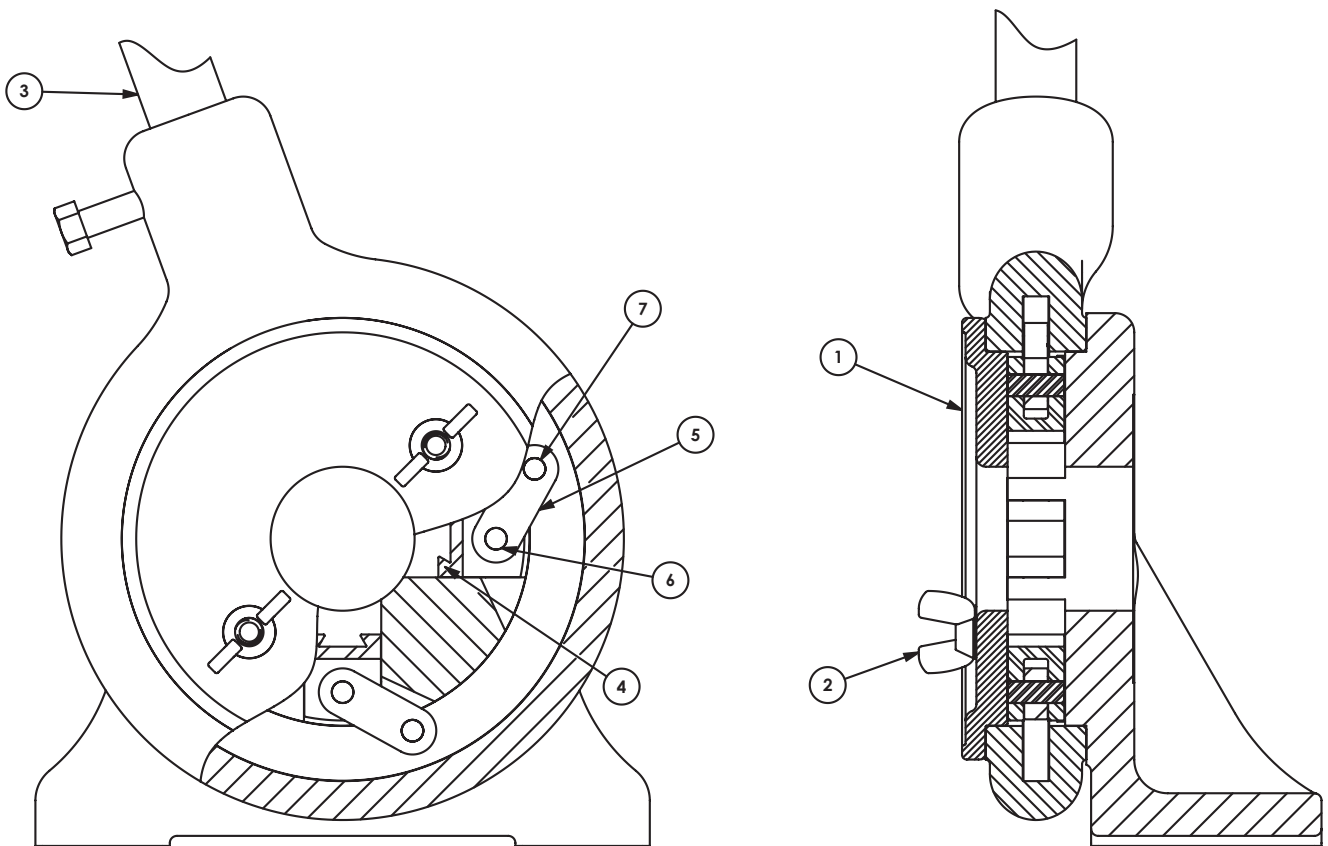

Parts List

Item #	Description	Qty	Part #
1	die holder plate	1	2551110003
2	3/8" - 16 wing nut	2	2551110006
3	handle	1	2551110008
4	die holder	4	2551110010
5	link	4	2551110011
6	die holder pin (short)	4	2551110012
7	link pin (long)	4	2551110013

