

GM-XXX

8-12-08

CUSTOMER DWG

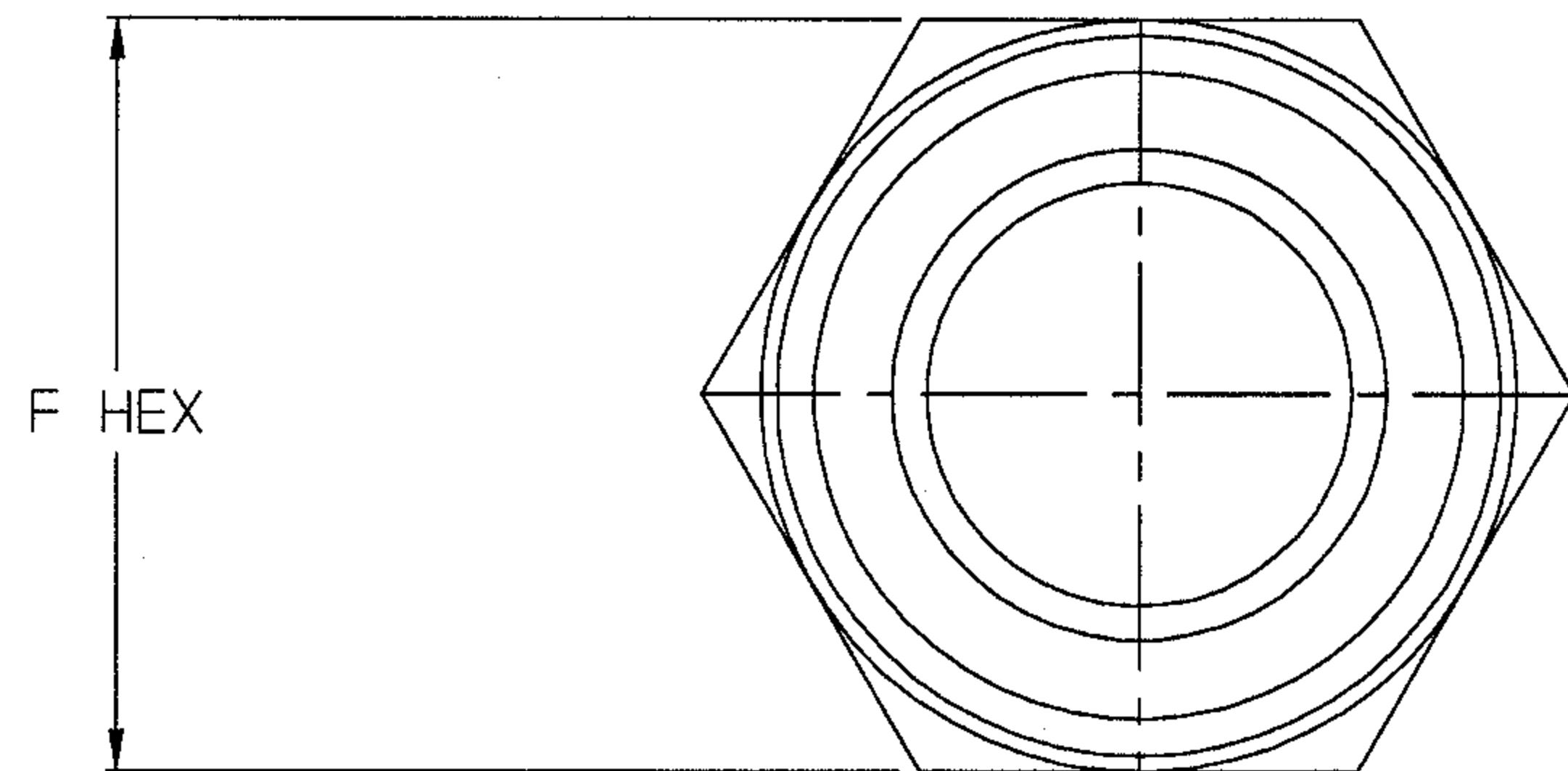
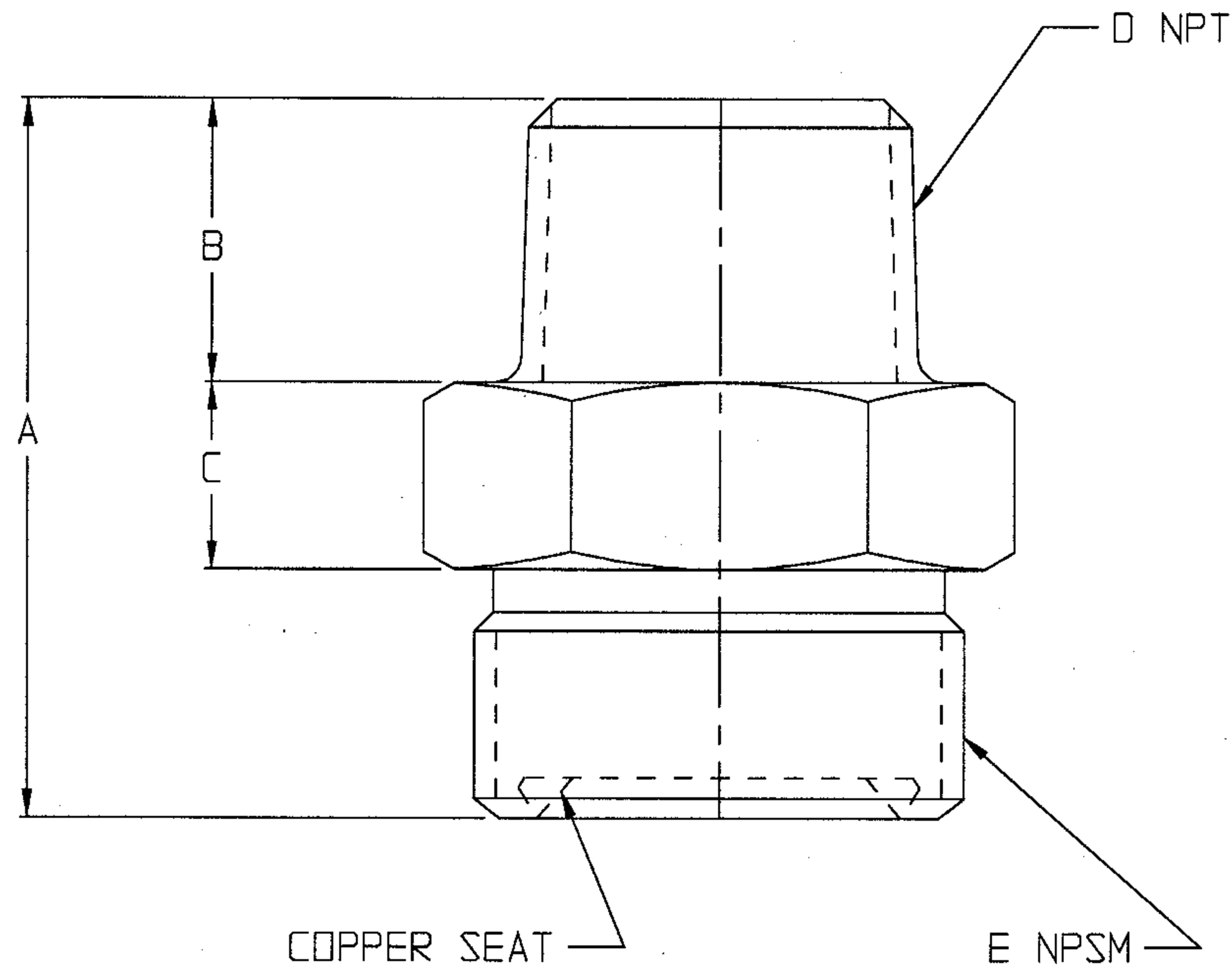

PART #	SIZE	A	B	C	D NPT	E NPSM	F HEX
GMB	1/4	1.1/8	1/2	5/16	1/4 - 18	1/2 - 14	7/8
GMC	3/8	1.3/8	1/2	3/8	3/8 - 18	3/4 - 14	1.1/16
GM-3C	1/2	1.7/8	13/16	7/16	1/2 - 14	1 - 11 1/2	1.5/16
GM-8C	3/4	2.3/16	13/16	9/16	3/4 - 14	1 1/2 - 11 1/2	1.7/8
GM-13C	1	2.3/8	1	9/16	1 - 11 1/2	1 1/2 - 11 1/2	1.7/8
GM-18C	1 1/4	3.1/8	1.1/4	11/16	1 1/4 - 11 1/2	2 - 11 1/2	2.7/16
GM-23C	1 1/2	3.1/8	1.1/4	11/16	1 1/2 - 11 1/2	2 - 11 1/2	2.7/16
GM-28C	2	3.3/8	1.3/16	15/16	2 - 11 1/2	2 1/2 - 8	3.3/32
GM-33C	2 1/2	3.7/8	1.5/8	1	2 1/2 - 8	3 1/2 - 8	4.1/8
GM-38C	3	4.7/16	2	1.1/8	3 - 8	4 - 8	4.7/8

NOTE:

GMB THRU GM-13C MADE FROM HEX C1215 STEEL.
LARGER SIZES MADE FROM GR. 32510 MALL. IRON.

CUSTOMER DWG

DIXON VALVE & COUPLING CO.
U. S. A.

TITLE

BOSS GJ MALE SPUD W/ COPPER SEAT

DRAWN BY: *WD*
7/15/96

CHECKED BY: *Di* 7/16/96

APPROVAL: *Dwb*
7/22/96

MAT'L
SEE NOTE

GM-XXX

AGREEMENT TO MAINTAIN CONFIDENTIALITY

This drawing is owned by Dixon Valve & Coupling Co. and shall be returned upon demand. It is loaned on condition that it shall not be copied or reproduced or submitted to others without the owners consent. In accepting it subject to this condition the recipient further agrees that this drawing or any design detail or concept disclosed herein shall not be used in any way detrimental to or in competition with the Owner. If the recipient does not agree to the terms of this agreement, they shall return this drawing immediately.

